

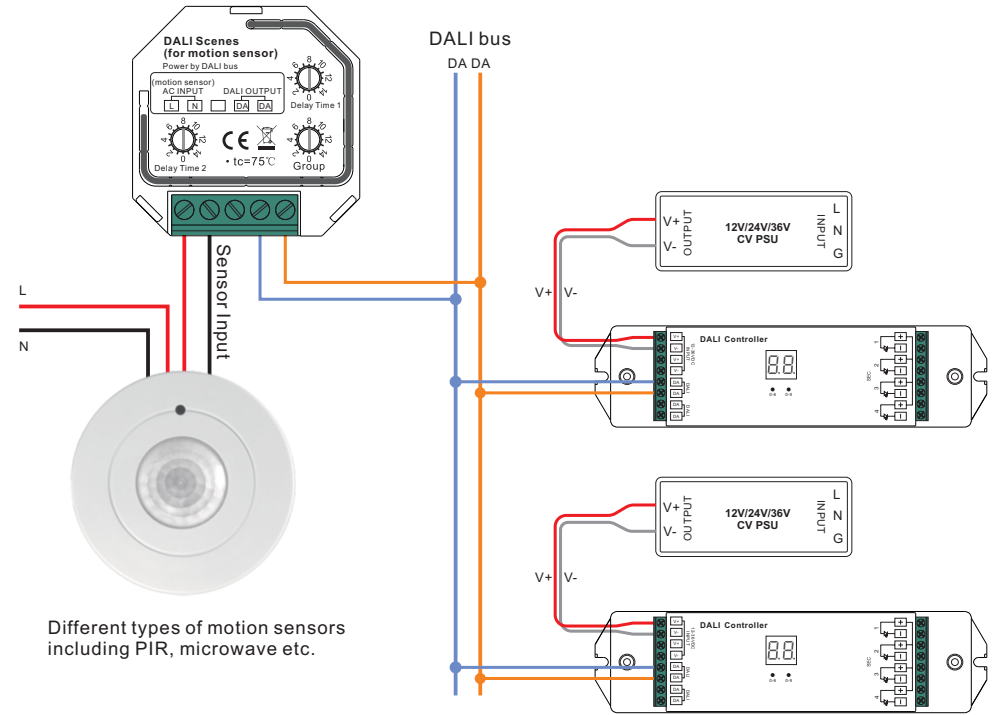

**Important:** Read All Instructions Prior to Installation

### Function introduction

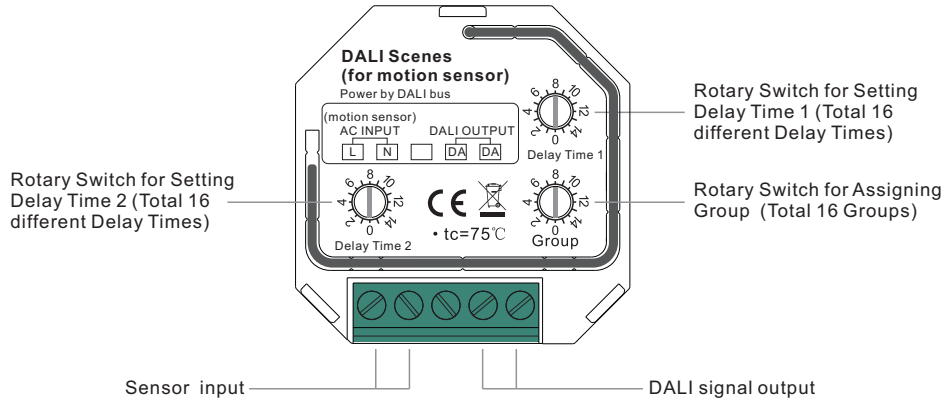

### Product Data

Output	DALI signal
Power Supply	Supply By DALI Bus
Operation Current	4mA
Operating temperature	0-40°C
Relative humidity	8% to 80%
Dimensions	45.5x45x20.3mm

- Control up to 16 different groups.
- Control all devices on DALI circuit through broadcast.
- Recall 3 fixed predefined DALI scenes.
- Enable to set 16 different delay times.
- Can connect with different motion sensors.
- Can connect with different types of motion sensors including PIR, microwave etc.
- Each DALI bus can install multiple scene controllers, consumption current of each controller is 4mA.
- Multiple motion sensors can be connected to one scene controller for multi operation points.

### Safety & Warnings

- DO NOT install with power applied to device.
- DO NOT expose the device to moisture.

### Operation

**1. Do wiring according to connection diagram correctly.**

**2. Set starting Group number via rotary switch on the back: (0-15 selectable)**

- This DALI scene controller enables Group selection commands to be sent to 1 Group of DALI devices on the DALI circuit for Scene control. A rotary switch is used to select the DALI Group you would like to control and set the starting Group number, and total 16 Groups (0-15) can be selected.
  - When the rotary switch arrow position is at 0, all devices on DALI circuit will be selected for Scene control through broadcast.
  - When the rotary switch arrow position is at X except 0 (1-15), devices in DALI Group X-1 will be selected for Scene control.
- For example: Rotary switch arrow at 1, DALI Group 0 will be selected. Rotary switch arrow at 15, DALI Group 14 will be selected.

Note: Please configure the slave controllers on DALI circuit to the DALI Group you would like to select with DALI master. Please refer to the detailed Group setting table as follows:

Rotary Switch Position	0	1	2	3	4	5	6	7	8	9	10	11	12	13	14	15
DALI Group Selected	Broadcast	0	1	2	3	4	5	6	7	8	9	10	11	12	13	14

### 3. DALI Scenes to be recalled

3 fixed predefined DALI scenes will be recalled by the DALI scene controller and the command will be triggered by the connected motion sensor:

When presence of a human being is detected within detection range in a room, a predefined scene S1 will be triggered and recalled to the selected DALI Group.

When absence of the human being is detected within detection range after the time he stayed in the room, a predefined scene S2 will be triggered and recalled to the selected DALI Group. The time that the selected DALI Group needs to reach light value of S2 from value of S1 can be set by the rotary switch Delay Time 1 on the back.

The scene S2 will last for a period depending on the selected Delay Time 2, when the delay time elapsed, a predefined scene S3 will be triggered and recalled to the selected DALI Group.

S1, S2 and S3 will be fixed to the last three DALI Scenes (13, 14, 15 or 14, 15, 16 depending on different starting DALI Scene number 0 or 1 stored in slave controllers).

Note: Please configure light value of the last three DALI Scenes to the slave controllers on DALI circuit with DALI master.

### 4. Set Delay Time 1 (from S1 to S2)

The time that the selected DALI Group needs to reach light value of S2 from value of S1 can be set by the rotary switch Delay Time 1. Once absence of human being is detected, the scene S1 will fade to scene S2 within the selected Delay Time 1. Total 16 different delay times (0-15) can be selected, 0S means no fade, S1 directly goes to S2. The detailed selectable delay time 1 are as follows:

Rotary Switch Position	0	1	2	3	4	5	6	7	8	9	10	11	12	13	14	15
Delay Time1	0S	0.7S	1.0S	1.4S	2.0S	2.8S	4.0S	5.7S	8.0S	11.3S	16.0S	22.6S	32.0S	45.3S	64.0S	90.5S

### 5. Set Delay Time 2 (from S2 to S3)

A rotary switch is used to set Delay Time 2 from S2 to S3, once scene S2 is recalled, it will last for the Delay Time 2 and S3 will be recalled once time elapsed. Total 16 different delay times (0-15) can be selected. 0 stands for no delay, which means scene S1 will directly go to scene S3 without S2 being recalled. 15 stands for infinity, which means the Delay Time is infinite and scene S2 will never go to scene S3. The delay time selectable are as follows:

Rotary Switch Position	0	1	2	3	4	5	6	7	8	9	10	11	12	13	14	15
Delay Time2	0S	2S	5S	10S	30S	1Min	10 Min	20 Min	30 Min	40 Min	60 Min	90 Min	120 Min	150 Min	240 Min	Infinity

### Product Dimension

